

# Exemplar Scheme, Building Schools for the Future

by WilkinsonEyre

WilkinsonEyre, together with educational consultant Graham Parker, was selected by the DfES in 2003 to develop an exemplary secondary school design. The objective of the exemplar design exercise was to offer an architecture that supported innovative learning and teaching methods as well as providing a stimulating and fun built environment, adopting best practice from schools and other building types. The team took a kit of parts approach, developing a series of components that could be applied to a variety of different sites and scenarios. The basic building block is a two-storey 'learning cluster', each housing up to 300 students and arranged around a central agora, inspired by the ancient Greek marketplace.

The same team was then appointed to apply this exemplar scheme to the design of the John Madejski Academy in Reading, which opened in 2007 and was the first of the exemplar schemes to be built in the UK. The kit of parts has also been applied to several of the schools designed for the Bristol BSF initiative.

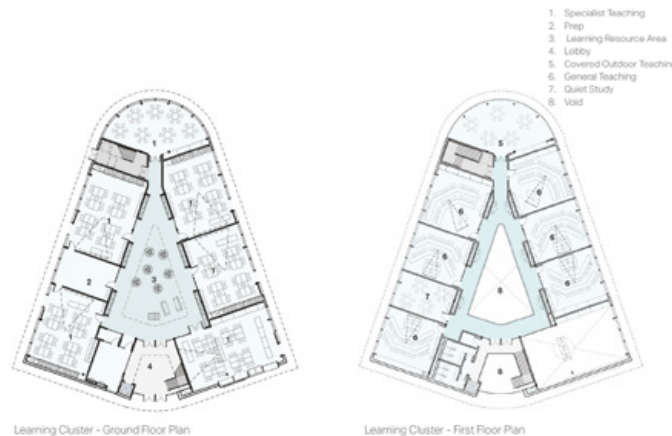
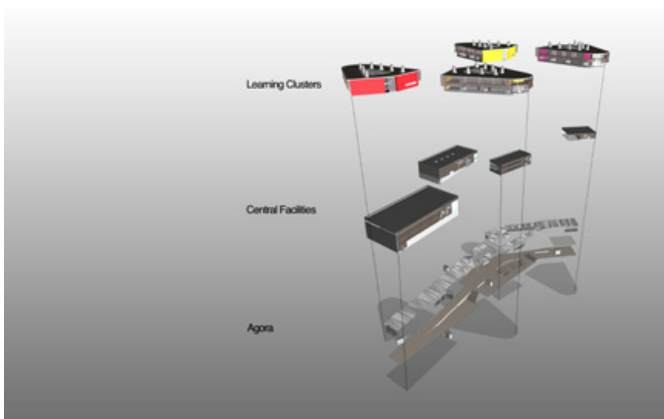

### Details

Locations: Various, UK  
 Client: N/A  
 Architect: WilkinsonEyre  
 Structural & Services Engineer: Arup  
 Date: 2003